

# Haus E

Soremattstrasse 10e

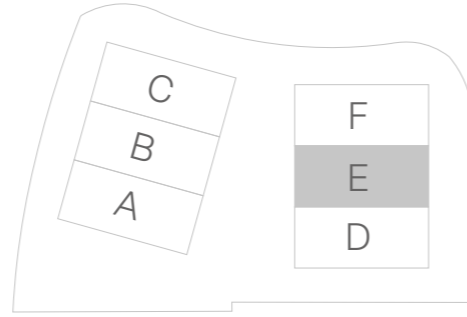

## 6.5-Zimmer Einfamilienhaus

Wohnfläche	167.8m <sup>2</sup>
Nebenflächen UG	24.5m <sup>2</sup>
Gartenfläche	ca. 24m <sup>2</sup>
Parzellenfläche	159m <sup>2</sup>
Parzellennummer	2586
Kubatur	890.0m <sup>3</sup>

## Erdgeschoss

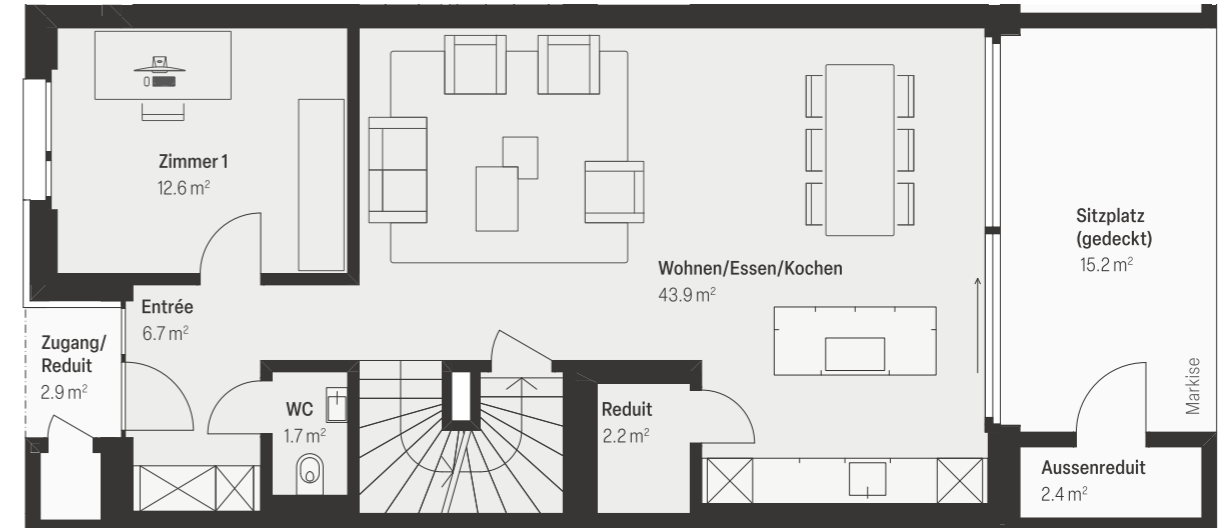

## Untergeschoss

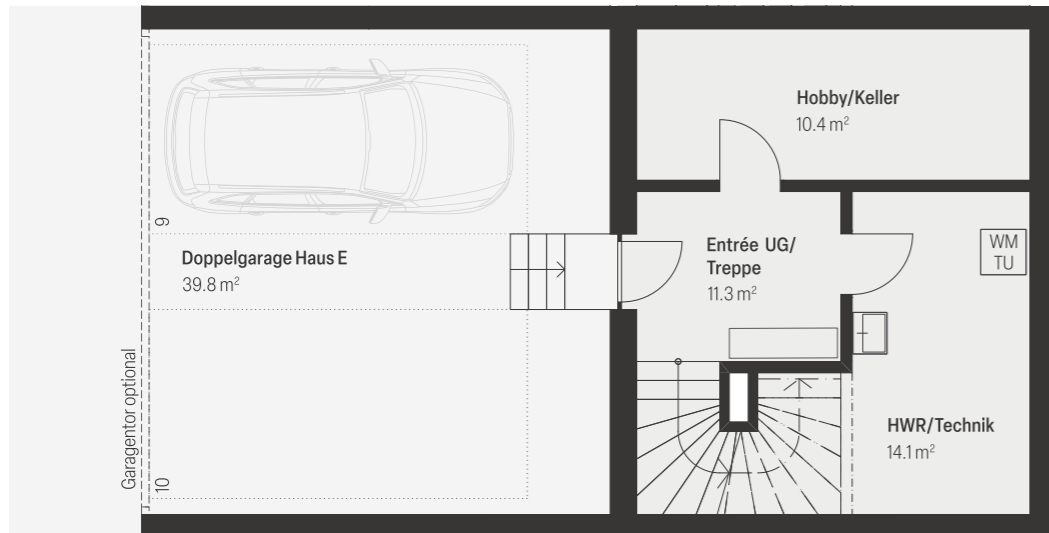

## Obergeschoss

